

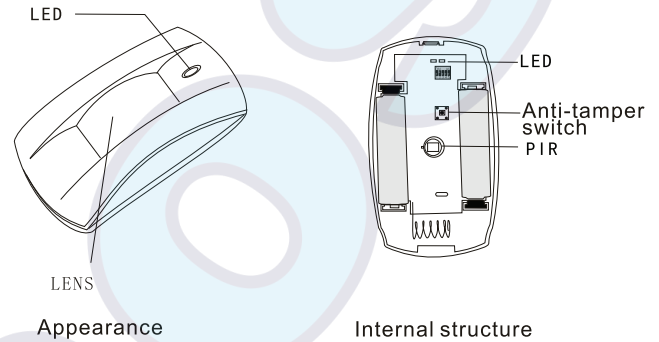

CLMD-448R DMT

1.Introduction

CLMD-448R DMT is a style of intelligent direct-recognize curtain PIR intrusion detector, it adopts energy-pile up logical process, random dynamic time split technology. CLMD-448R DMT series adopt precision column lens to upgrade receiving effect, with high sensitivity but without false alarm. It can recognize direction, and install mode optional. With anti-tamper function, you have no worry about someone to dismantle. Fit for indoor installation, and work with common battery, unique energy-svaing mode enable the work life of battery longer than one year.



2.Specification

Model: CLMD-448R DMT

Detect angle:20°

Detect distance: 6m/25°C

Transmit distance: 150m (open air)

Input voltage: 3VDC (2*1.5V)

Current consumption :

Static $\leq 25 \mu A$, Alarm $\leq 15mA$ (433MHz)

Static $\leq 25 \mu A$, Alarm $\leq 50mA$ (868MHz)

Alarm output: wireless signal transmitting

Anti-tamper output: wireless signal transmitting

Transmitting frequency: 433MHz/868MHz

LED indication Red LED and Blue flashing at the same time: alarming; Blue LED flashing alone: detect people move in the right direction, but no alarming (when you turn pirection function ON)

Note: when low battery, please change new one in time.

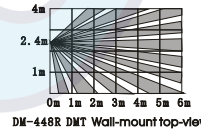
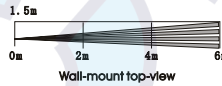
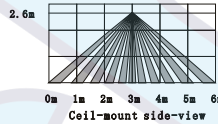

wall mount height: 1.6-2.4m

Ceil mount height: 2.5-4m

Woking temperature: -10°C-50°C (14°F-122°F)

Storage temperature: -20°C-60°C (-4°F-140°F)

Anti white light: more than 8000 LUX

Anti EMI: more than 30V/m 30MHz-1GHz

Dimension:

(L*W*H) : 90*50*40mm

3.installation

3.1 General guidelines

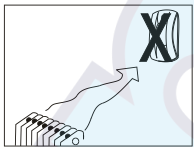

Do not face cold or hot directly

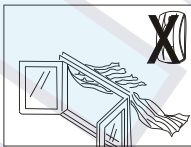

Do not open the window in protect area

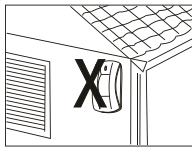

Do not install outdoor

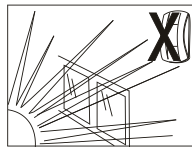

Do not face the sun directly

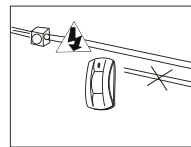

Do not instal near high voltage cable



Do not install on a loose basement

3.2 installation

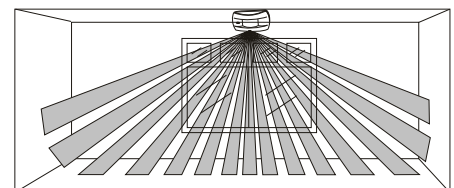
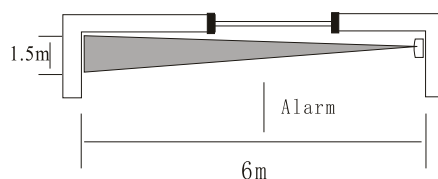
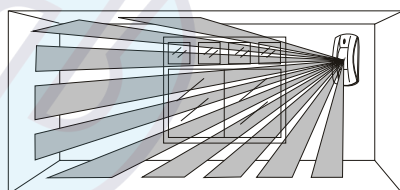

3.3 On installation procedure

① Disassemble unite:

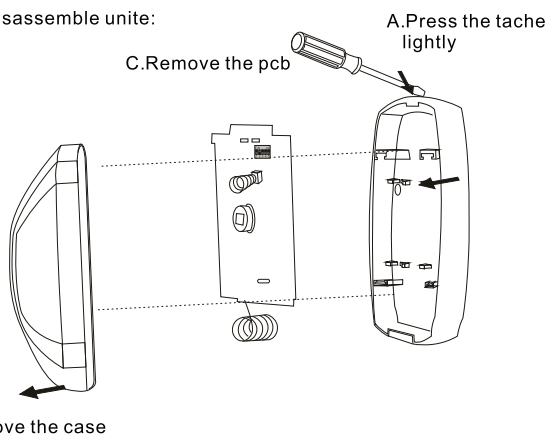

② Install the base cover:

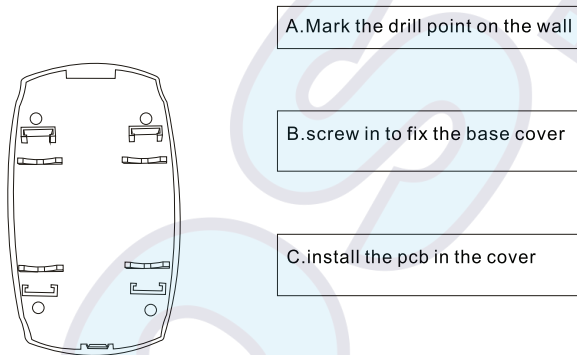

3.4 Instruction of code switch

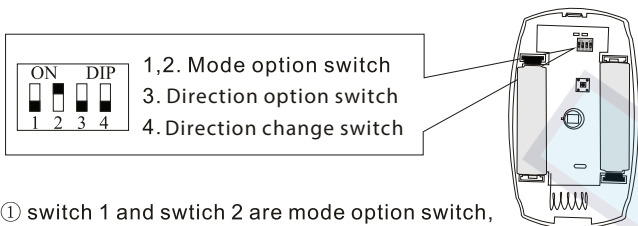

① switch 1 and switch 2 are mode option switch, work mode see below:

1	2	Work mode
ON	OFF	Test mode
OFF	ON	Power save mode
OFF	OFF	Coding mode

The detector can set below three work mode:

Test mode: there are 20s dormancy stage after detector alarm. It won't alarm within dormancy stage. This model as factory default.

Power-saving mode: there are 3 mins dormancy stage after detector alarm, and no alarm within this period.

Coding mode: press the anti-tamper switch for 3s, and send a code to receiver

② Function of Switch 3 and switch 4 see below

Switch	Function	Default
3	Direction option switch	OFF
4	Direction convert switch	OFF

Switch 3: Direction **option** main switch. When set this switch "ON", direction recognize function is effective, when set "OFF", direction recognize function is ineffective.

Switch 4: Direction convert switch. If set this switch "OFF" and detect direction is from left to right, then you can set this switch "ON", the direction is from right to left.

Switch 5: alarm delay or instant option switch. set switch 1 and switch 2 as test mode and set direction recognize switch 3 as On. and this switch set OFF. Then if user pass through the permit direction and trigger the detector, but if user get back in 15seconds, the detector won't make alarm. If after 15s, user get back through the protect area, the detector will make alarm. Set switch 3 "ON", switch 5 "ON", if trigger the detector, and pass in non-permit direction in 3minutes the detector won't make alarm. If pass in non-permit direction it will make alarm. [we suggest user set switch 5 OFF (15s) under normal work mode].

Note: when direction recognize function On, in 5meters it can recognize direction clearly, but if further than 5 meters will cause false discriminate.

3.5 Code to control panel

Make sure first the detector is under coding mode, then press the anti-tamper for 3s then release. After hear the panel's indication sound then finish coding. About the panel coding setting please read the manual of panel.

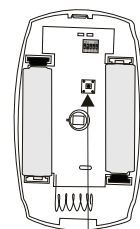

Press this switch to code

